



## Freflow V3 Respiratory Welding Helmet

### Product Features



#### Flip-Up-Design

Easy lift up for Grinding Function, Suiting Welding / Cutting / Grinding mode.

#### Large View for Grinding

20 x 12 cm area, Large and curved transparent grinding anti-fog lens.



#### Rechargeable Li-ion Battery

Rechargeable battery for longer lifetime.  
Fast-charging option makes charging only 1 hour.

Filter efficiency  
**≥ 99.97%**

#### Respiratory Protection

Filter efficiency  $\geq 99.97\%$ , Preventing inhalation of dust, pollutants, fine particles as well as other contaminants.

#### Intelligent Air Supply

Respirator will self-adjust the flow rate according to the blockage of the filter automatically.

#### Real-Time Display Indicator

Filter status / airflow rate / battery capacity indicator, real-time monitoring and displaying.

#### Auto-Alarm System

Flashing indicator, beeping sound, together with vibrating blower to ensure safety.

**SAFETY IS EVERYTHING**

#### Easy Operation



#### Wide Application



#### Cured 3D Feature



#### Applicable with PAPR



#### Hard hat Adapter



#### Patented Headgear



#### High-Impact Resistance



#### Side Lens



### Respirator Specifications

Airflow Rate	Low Speed - 170+lpn (6+cfm) High Speed 210+lpn (7.4+cfm)
Battery Type	Rechargeable Li-ion Battery
Battery Duration	9 Hours (Standard Battery) 170+lpn 5-6 Hours (Standard Battery) 210+lpn 15 hours (Extended Battery) 210+lpn 9 Hours (Extended Battery) 210+lpn
Battery Charge Time	1 Hour (Standard Battery) 2 Hours (Extended Battery)
Battery Life	500 Charges
Filter Efficiency	99.97%
Alarms	Visible, Audible and Vibrate
Operating Temp	-5°C - +55°C (23°F - 131°F)
Storing Temp	-10°C - +55°C (14°F - 131°F)
Operating Relative Humidity	< 90%
Storage Relative Humidity	< 85%
Weight (Blower unit and Battery)	1020g
Respirator Approved	EN12941 TH3 P R SL NIOSH 42 CFR PART 84 AS/NZS 1716

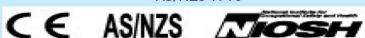

### ADF Specifications

Optical Class	1 / 1 / 1 / 1
Viewing Area	107 x 75 mm (4.21" x 2.95")
Cartridge Size	156 x 123 x 33 mm (6.14" x 4.84" x 1.30")
Arc Sensor	4
Light State	DIN 4
Grind State	DIN 4
Cutting Shade	Shade No. from 5 to 8
Welding Shade	Shade No. from 9 to 13
Shade Control	Internal, Digital Display Control
Power On / Off	Automatic On / Off
Sensitivity Control	Low - High, Digital Display Control
UV / IR Protection	Up to shade DIN16 at all times
Power Supply	Solar cell. Battery replacement 2 x CR2450 Lithium Battery
Switching Time	1/25,000 s. from Light to Dark
Grinding	Yes
Delay (Dark to Light)	0.1 - 1.0 s, Digital Display Control
Low Amperage TIG Rated	$\geq 2$ amps (DC); $\geq 2$ amps (AC)
Operating Temp	-10°C - +55°C (14°F - 131°F)
Storing Temp	-20°C - +70°C (-4°F - 158°F)
Helmet Material	High Impact Resistance Nylon
Approved	DIN 4, CE, SP, ANSI Z87.1, AS/NZS



**THADHANI**<sup>®</sup>  
The Experts in Safety... Since 1947

J.THADHANI & CO.

New #12/ Old #28, Stringers Street,  
Chennai - 600001, Tamilnadu, India.



044 - 4262 5223



info@thadhanisafety.com



www.thadhanisafety.com



Flip-up design

Easy lift up for grinding function, suiting welding / cutting / grinding mode.

Large view for grinding

20 x 12 cm area, large and curved transparent grinding lens.

Auto-alarm system

Flashing indicator, bleeping sound, together with vibrating blower to ensure safety.

Rechargeable Li-ion battery

Rechargeable battery for longer lifetime. Fast-charging option makes charging only 1 hour.



Respiratory protection

Filter efficiency ≥ 99.97%, preventing inhalation of dust, pollutants, fine particles as well as other contaminants.

Intelligent air supply

Respirator will self-adjust the flow rate according to the blockage of the filter automatically.

Real-time display indicator

Filter status / airflow rate / battery capacity indicator, real-time monitoring and displaying.

Tecmen® PAPR Freflow V3 system  
Part No. SAFE4033

PAPR Specification

Air flow rate:	Low speed: 170 lpm High speed: 210 lpm
Battery type:	Rechargeable Li-ion Battery
Standard Battery duration:	9 hours Low/ 5 hours High
Heavy Duty Battery duration	15 hours Low/ 9 hours high
Battery charge time	1 hour - Standard 2 hours - Heavy Duty
Battery life:	550 charges
Filter efficiency:	99.97%
Alarms:	Visible, Audible and Vibrate
Operating temperature:	-5°c to 55°c (23° to 131° F)
Weight:	1.2 KG
Standard:	EN 12941 TH2, NIOSH 42 CFR 84 AS/NZS 1716

ADF950S iEXP Specification

Optical Class:	1 / 1 / 1 / 1
Viewing Area:	107 x 75mm
Cartridge Size:	156 x 123 x 33mm
Arc Sensor:	4
Light State:	DIN 3.5
Dark State:	DIN 5 - 8 / 9 -13
Shade Control:	Internal, Digital Display Control
Power On/ Off:	Manually On/ Off, Auto-off
Sensitivity Control:	Low-High, Digital Display Control
UV/ IR Protection:	Up to shade DIN16 at all times
Power Supply:	Solar cell. Battery Replaceable, 2 x CR2450 lithium battery
Switching Time:	1/25,000 s. From light to dark
Delay (Dark to light):	0.1 ~ 1.0s by dial control knob
Low Amperage TIG Rated:	≥ 2 amps (DC); ≥ 2 amps (AC)
Grinding:	Yes
Application range:	MMA, TIG, TIG Pulse, MIG, MIG Pulse, Plasma Cutting, Plasma Welding, Arc Air Gouging, Grinding.
Approved by:	DINplus, CE, ANSI Z87.1, CSAZ94.3, AS/NZS 1338.1



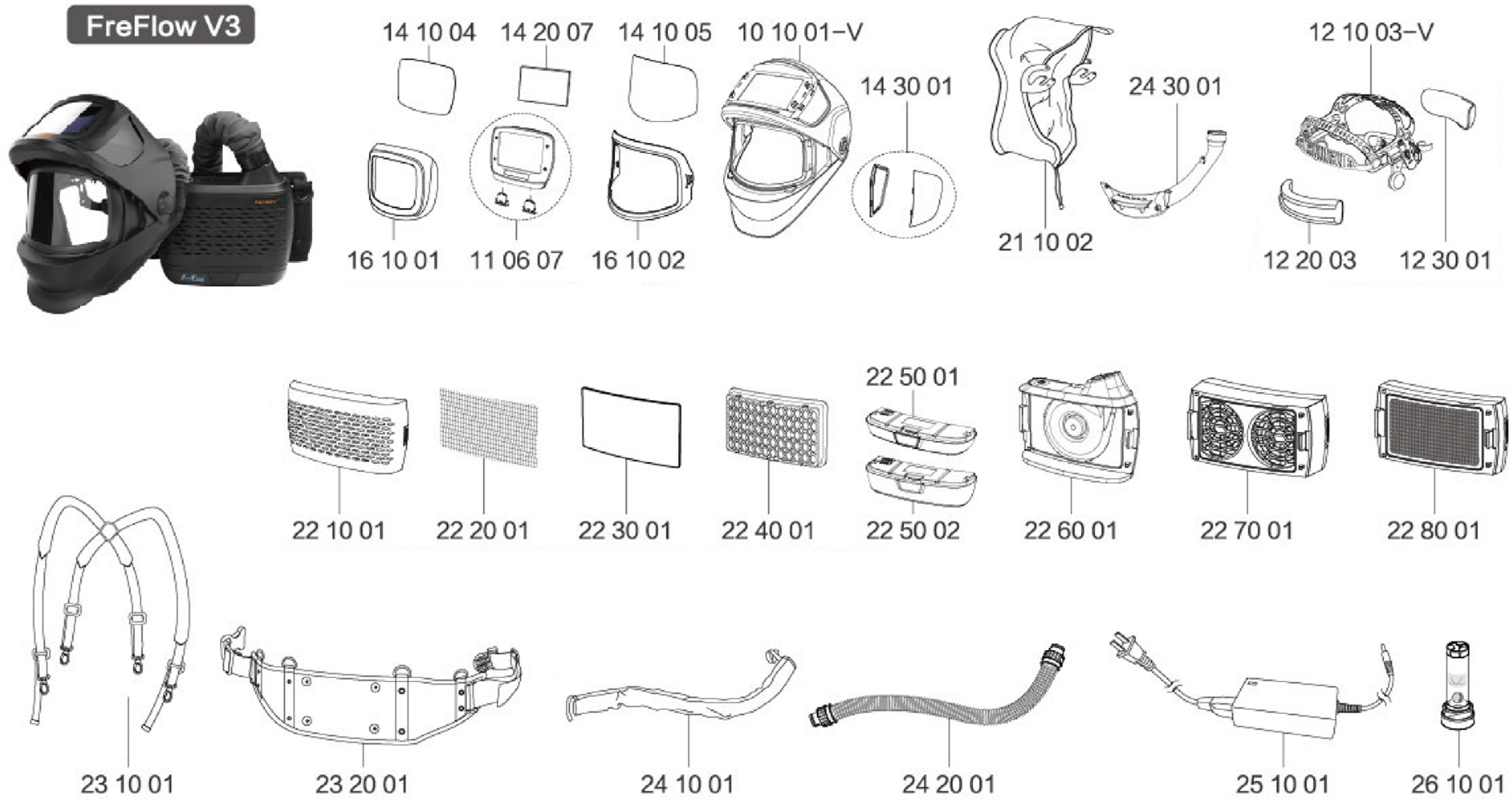

Part No.	Description
SAFE4021	Face Seal (21 10 02)
SAFE4022	Headband (12 10 03-V)
SAFE4023	Air duct (24 30 01)
SAFE4024	PKT (2) Sweatband (12 20 03, 12 30 01)
SAFE4025	Helmet Shell (10 10 01-V)
SAFE4026	Front lense retainer (16 10 01)
SAFE4027	Front cover lense (14 10 04)
SAFE4028	Auto darkening filter (11 06 07)
SAFE3026	Battery for ADF
SAFE4029	Inner Lense (14 20 07)
SAFE4030	Grinding Lense holder (16 10 02)
SAFE4031	Grinding Lense (14 10 05)
SAFE4032	Side windows 2pcs (14 30 01)
SAFE3862	Blower unit body only (22 60 01)

Part No.	Description
SAFE3863	Standard Battery (22 50 01)
SAFE4018	Heavy Duty Battery (22 50 02)
SAFE3864	Particle Filter P3 (22 40 01)
SAFE4019	Gas Filter (22 70 01)
SAFE4020	Odour Filter (22 80 01)
SAFE3865	PKT (5) Pre filter (22 30 01)
SAFE3866	Spark Protection (22 20 01)
SAFE3867	Filter cover (22 10 01)
SAFE3868	Shoulder Strap (23 10 01)
SAFE3869	Waist Belt (23 20 01)
SAFE3870	Cover for breathing tube (24 10 01)
SAFE3871	2 PCS 'O' Ring for breathing tube
SAFE3872	Breathing tube (24 20 01)
SAFE3873	Battery Charger (25 10 01)
SAFE3874	Air Flowmeter (26 10 01)